

3rd ANGLE (AMERICAN) PROJECTION

DIMENSIONS IN INCHES. DO NOT SCALE PRINT
DIMENSIONS THUS [] IN MM.

NUMBER C154708

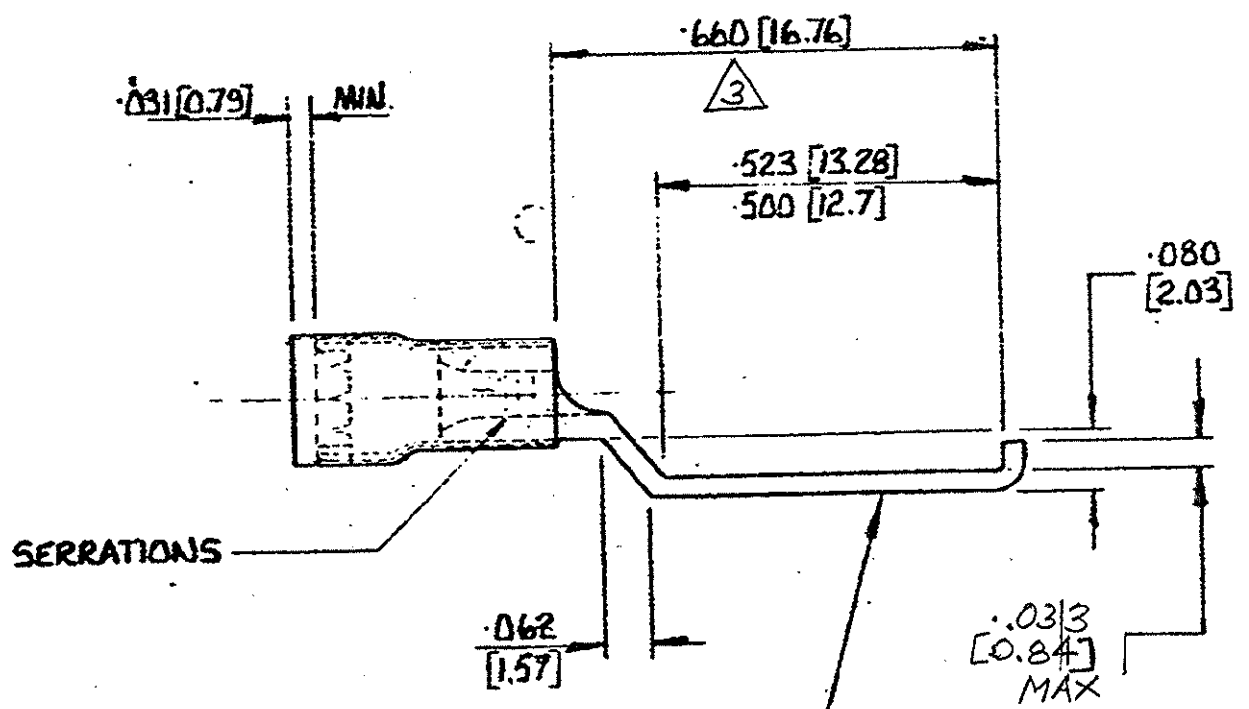
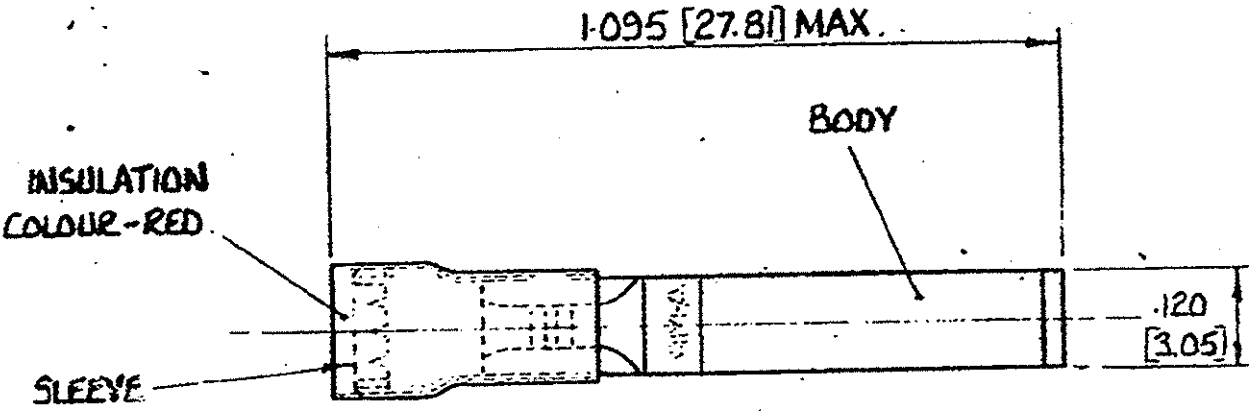

- 1 TONGUE MATERIAL THK = .031 [0.79]
- 2 WIRE INSUL. DIA .105-.140, TO SUIT .145 [3.68] DIA
- 3 FROM EDGE OF METAL WIRE BBL TO EDGE OF LIP.

				© AMP of GREAT BRITAIN LTD 1973		CUSTOMER COPY REFERENCE ONLY	
				MATERIAL AND FINISH COPPER TIN PLATE. P.V.L.		AMP of Great Britain Ltd	
				WIRE - GAUGE - INSULATION 22 - 16		TERMINAL HOUSE, STANMORE, MDDX.	
				TYPE P.I.D.G.		CLASS	
				TOLERANCE EXCEPT AS NOTED ± 0.15 P.30; ± .1"		SCALE 4:1	
				LOC E A		NO C-154708	
				NAME ASSY TERMINAL BLADE		REV A	
LTR		REVISION RECORD		DR	CHK	DATE	
A		Rev. PCL 263A-0002-04		NR	Tm	3/04	
O		REL FOR PROD		KRD		31.10 73	
DR		K.R. DORRANT		CHK		4/10/73	

PRINT COST.